



OUR VISION IS TO BE THE GLOBAL LEADER IN CREATING
SUSTAINABLE PACKAGING SOLUTIONS FOR A BETTER WORLD

Visy Industries Australia Pty Ltd

Visy Waste Management Facility at 43 Bay Road Taren Point

Operate a Resource Transfer Station (TRF) or a Materials Recycling Facility (MRF) or a combination of both a TRF and MRF with a maximum annual throughput of 60,000 tonnes per annum (tpa) and allow for 24-hour operations Mondays to Fridays, with operations from 6:00 am to 4:00 pm Saturdays, Sundays and public holidays

History



- Commenced 2001
- Consent for 30,000 tpa
- Later consent for 45,000 tpa not formally commenced
- Fire in 2019, with repair works completed under DA19/0921
- Has mostly operated as a MRF

Principal Planning matters

- In IN1 General Industrial zone
- A TRF accepts recycled material from Council waste trucks then transfers the material to a MRF for sorting
- A MRF receives and sorts recyclable materials for reuse or reprocessing
- Designated development: a waste management facility
 - with an intended capacity of more than 30,000 tpa
 - located on a floodplain
 - on acid sulfate soils
- Is regionally significant development
- Existing environment protection licence under the POEO Act
- Flood prone on the western boundary with Alexander Avenue and in the centre of the site in the PMF
- Surrounding development is generally industrial with aged care 145m to the west and a retirement village 300m to the north
- No works are proposed

Comparison of existing to proposed facility

- Remove uncertainty regarding validity of consents
- Increase throughput from 30,000 to 60,000 tpa
- Set out hours of operation – 24 hours Monday to Friday and 6am to 4pm weekends and holidays
- Increase staff due to increase in shifts – from 19 to 45 weekdays and 3 to 17 weekends
- Increase truck movements in am peak period from 14 to 18

Table 3.1 – Comparison of the existing and proposed facility

	Existing	Proposed	Change
Tonnes per annum (tpa)	30,000 tpa	60,000 tpa	Increase by 30,000 tpa
Operational days	6 (Monday – Saturday)	7 (Monday – Sunday)	Include Sunday
Number of weekday shifts	2	3	Additional shift to allow for extended day time as well as night time operations
Number of weekend shifts	1 (Saturday)	2 (Saturday and Sunday)	Additional shift to allow for operations on a Sunday
Weekday staff requirements	19	45	Increase of 26
Weekend staff requirements	3	17	Increase of 14
Truck movements (AM Peak)	14 (7 in, 7 out)	18 (9 in, 9 out)	Increase by 4 (2 in, 2 out)
Truck movements (PM Peak)	2 (1 in, 1 out)	1 (1 in, 1 out)	No change

Traffic Management

- Net increase in truck movements of 34 weekdays and 4 Saturdays
- Increase in staff due to adding of another shift
- No additional staff on site at any time other than changeover
- Trucks continue to access and leave the site from Bay Road

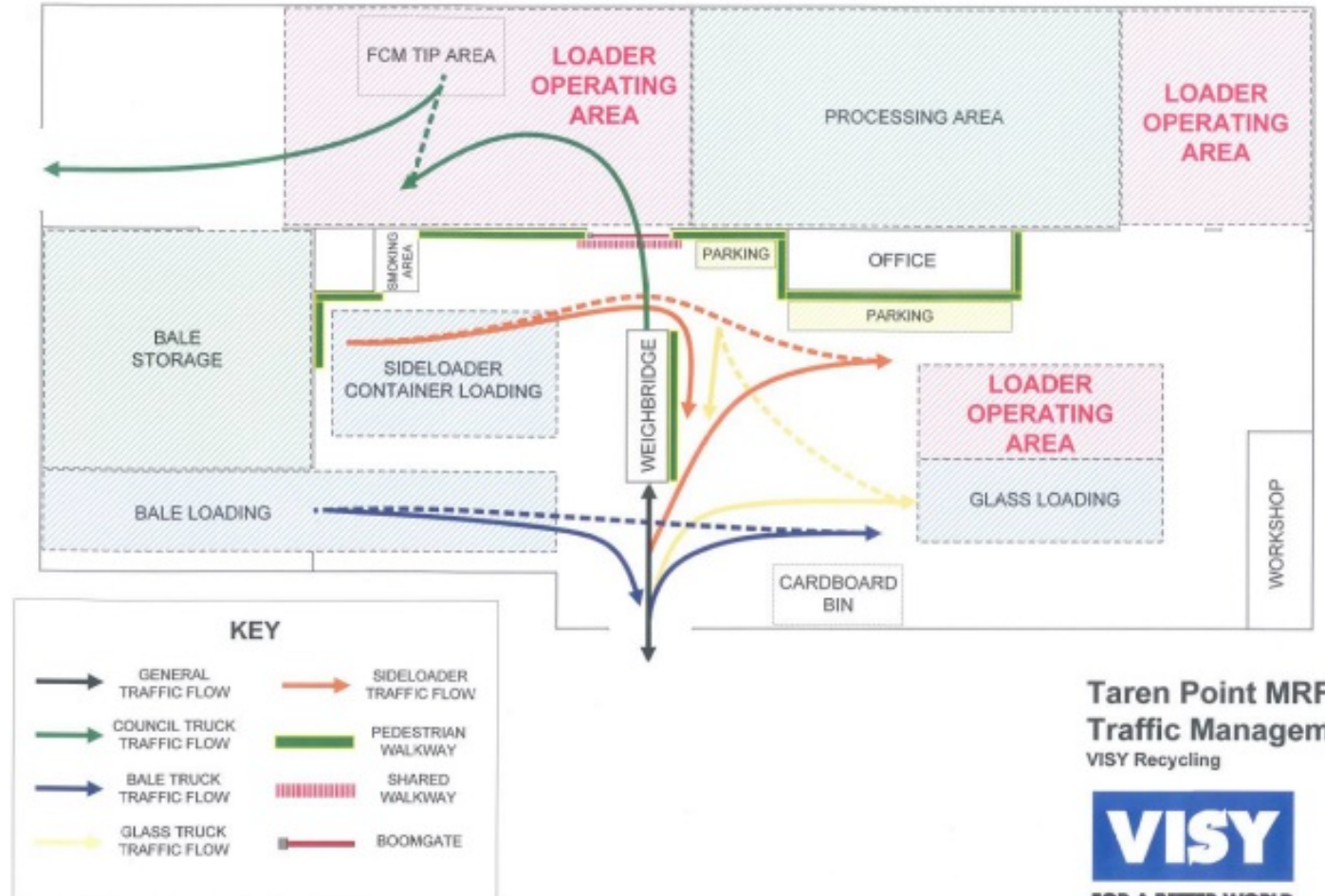

Taren Point MRF
Traffic Management
VISY Recycling



Operational Layout and stockpile zones

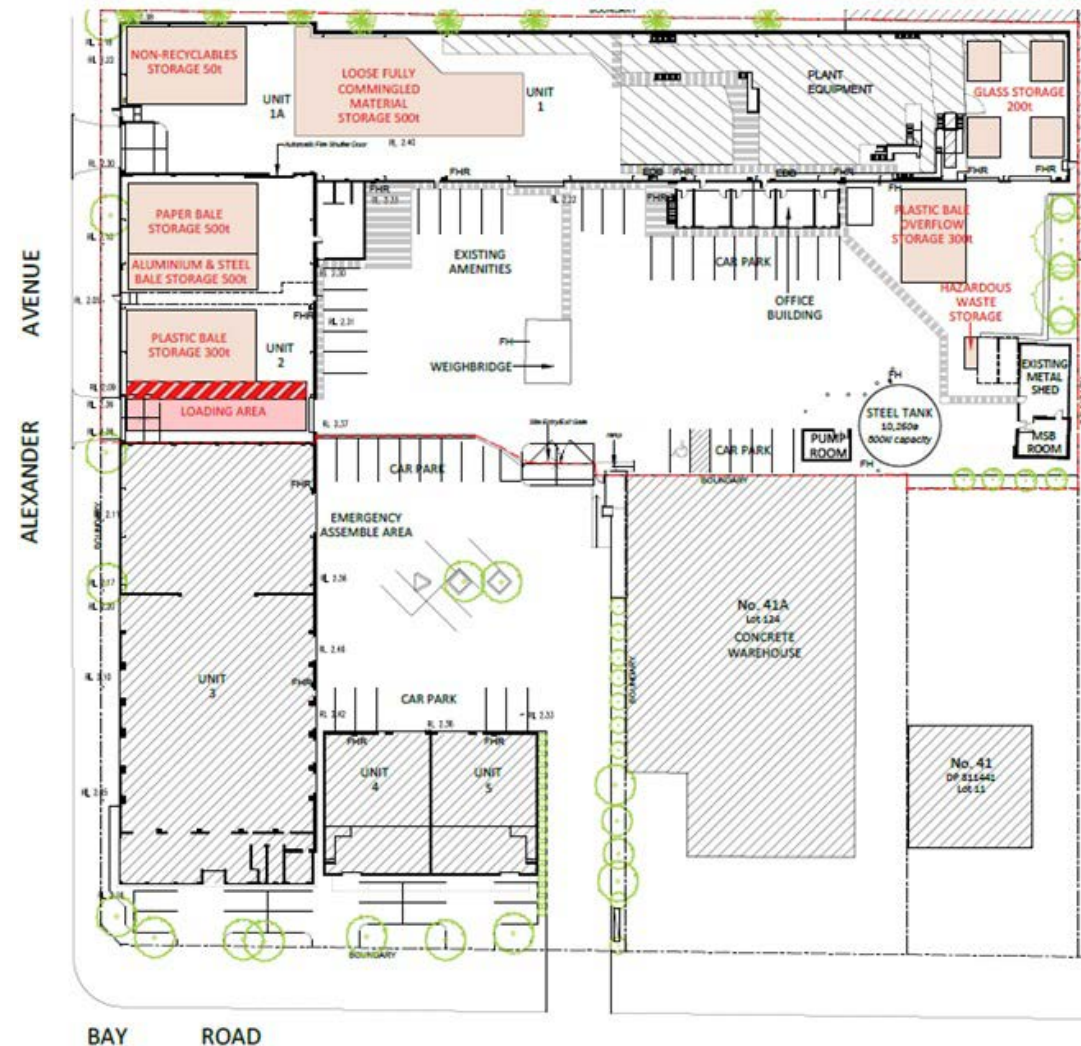

Photos of site



Inside Unit 1 looking east over the MRF processing equipment

Inside unit 1 looking west to Unit 1A. Roller door to Alexander Avenue with stockpile



Noise and Air

- Using standard noise management found that:
 - MRF can operate at all hours
 - Two roller doors on the south side must be shut between 10pm to 5am when access is not required
 - Front end loader can only operate inside (not outside) between 10pm and 5am
- Air quality assessment:
 - No additional exceedances of 24 hour criteria
 - Annual PM10 concentrations comply with criteria
 - Annual PM2.5 concentrations to increase by 1% above existing ambient concentrations

Hazards and risk

- No hazardous waste is accepted
- Materials kept on site are not potentially hazardous
- Fire engineering review prepared. Works were done and fire system upgraded under DA19/0921. No further works required.
- Flooding:
 - flood evacuation plan provided
 - Concrete bunding installed under DA19/0921 for fire water retention at 410mm above the 1% AEP
 - Hazardous items stored on a pallet or hardstand

Community consultation and exhibition

- Letterbox drop to 72 neighbours in 2020. No issues or comments received in response
- EPA sought assessment requirements for:
 - waste management
 - Air quality
 - Noise
 - water management
 - Odour
 - Fire
- Council raised:
 - BCA (fire)
 - Air quality and other health matters
 - Traffic
 - Flooding concerns
- Transport for NSW – note EIS erroneously states in Table 5.3 that TNSW had not responded
 - Intersection impacts
 - Cumulative study area
 - Non car travel modes

Justification

- Assists in promoting the circular economy in NSW and the surrounding LGAs and waste reduction targets
- Diverts waste to landfill
- Provides employment for an additional 26 people
- Over time the site will reach capacity requiring Council trucks to transport to an alternative site, leading to increase recyclable collection costs
- This is a cost effective and space efficient operation